

**△△ SPECIFICATION**

Current Rating:1A AC/DC  
 Voltage Rating:125V AC/DC  
 Dielectric Voltage:250V AC For One Minute  
 Contact Resistance:20 Milliohms Max.  
 Insulation Resistance:100 Megaohms Min.  
 Operation Temperature:-40°C~+85°C  
 Insulator:HTN(UL94V-0),Nature  
 Contact:Brass,Tin Plated Over Nickel  
 RoHS Compliant

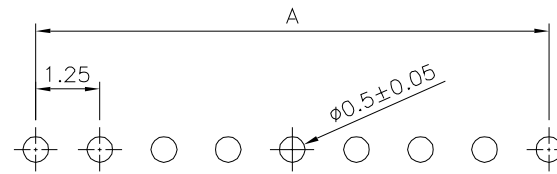

△△ Recommended P.C.B. Layout

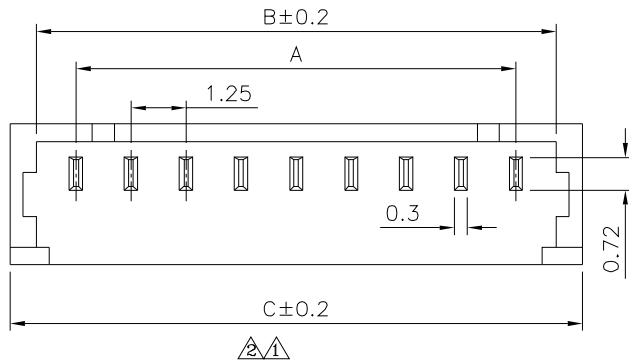
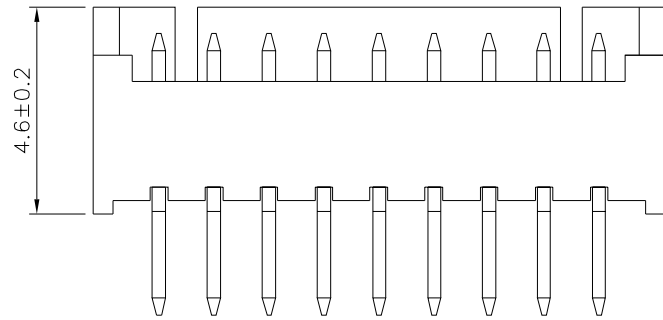

△△ 4P-15P

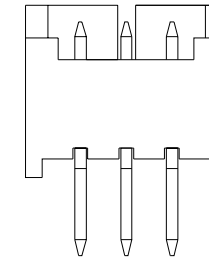
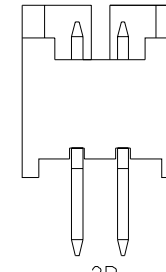
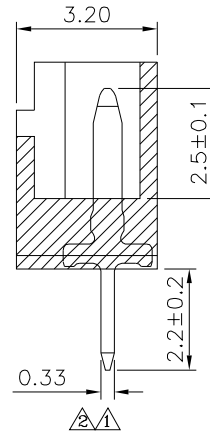
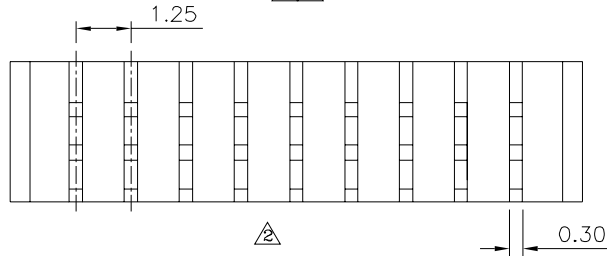

△△ Lock Window View

△△

Pin	A	B	C
02	1.25	3.15	4.25
03	2.50	4.40	5.50
04	3.75	5.65	6.75
05	5.00	6.90	8.00
06	6.25	8.15	9.25
07	7.50	9.40	10.50
08	8.75	10.65	11.75
09	10.00	11.90	13.00
10	11.25	13.15	14.25
11	12.50	14.40	15.50
12	13.75	15.65	16.75
13	15.00	16.90	18.00
14	16.25	18.15	19.25
15	17.50	19.40	20.50

**4UCON** 元化興業股份有限公司  
 4UCON TECHNOLOGY INC.

DRAWING No. △  
 01202

APPROVED BY MEI  
 CHECKED BY HZF  
 DRAWING BY CYP

UNLESS OTHERWISE SPECIFIED TOLERANCES ARE  
 .X ±0.25  
 .XX ±0.15

SCALE NONE REV. B2 UNIT mm

NO.	REV.	REVISIONS	CHK	DATE
△	B2	Modify Data	HZF	02/26/2015
△	B1	Modify Data	HZF	12/04/2013
△	B0	NEW RELEASE	HZF	12/10/2009