

The information provided herein is from CONNELY Electronic Co., Ltd. and is confidential. Any disclosure to a party other than the recipient is prohibited. The intellectual properties and its rights contained herein, including but not limited to, trademarks, patents, copyrights, trade secrets, and technical know-how, are owned exclusively by CONNELY or its affiliates. Unauthorized use of the information herein, in any format or manner, CONNELY may enforce its intellectual property rights at its own discretion; failures or delays to exercise such rights does not constitute a waiver of such rights.

1                      2                      3                      4                      5                      6                      7                      8

REV.	DESCRIPTION	DRAWN	CHECKED	APPROVED
A	NEW RELEASE	JLZ 12/02/15'		
B	DRAWING UPDATE	JLZ 05/22/19'		

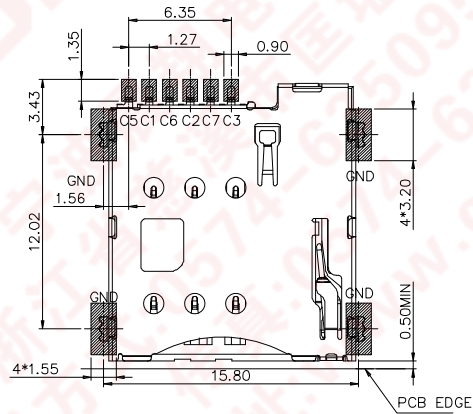
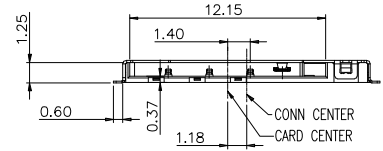
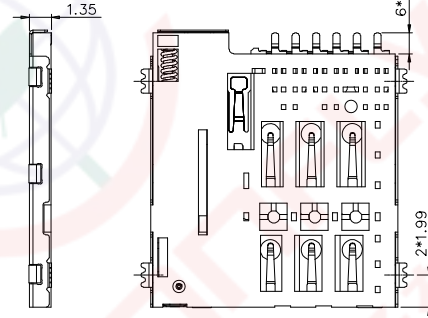
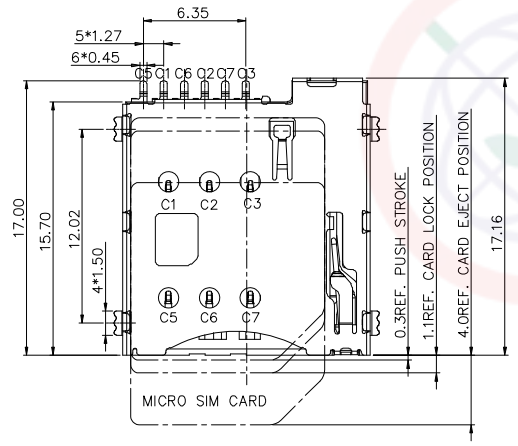
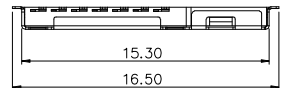

■ SMT SOLDER AREA  
 THERE SHOULD NOT BE ANY CIRCUITRIES  
 IN THE LAYOUT SPACE OF THE PRODUCTS  
 RECOMMENDED PCB LAYOUT  
 GENERAL TOLERANCE±0.05

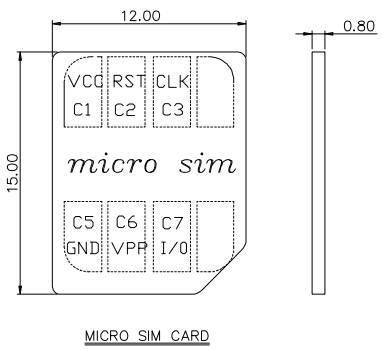

**Notes:**

- Material:
  - Housing: High Temperature UL 94V-0.
  - Contacts: Copper Alloy. Selective Gold Flash.
  - Shell:Stainless Steel.
- Specifications:
  - Operate Temperature: -40° C~+85° C
  - Insulation Resistance: 1000MΩ Min.
  - Contact Resistance: 50mΩ max.
  - Withstanding Voltage: 500V AC 1min.
  - Voltage Rating: 30V AC/DC
  - Current Rating: 0.5A
- Product Number Code:

DS1138-11 - XX X X X X X

- Packing Type  
R: Tape On Reel
- Housing color  
B: Black
- Contact Plating  
0: Selective gold flash
- Mounting type  
S: SMT type
- Connector type  
S: Socket
- No. of contacts  
06:6pin

GENERAL TOLERANCE		ANGLE TOLERANCE	
X.	±0.60	X.	±5°
.X	±0.38	.X	±3°
.XX	±0.25	.XX	±2°

PROJECTION	TITLE	Micro SIM Card Push Push H=1.35mm 6 Positions SMT Type	
	mm	SHEET SIZE	A4
UNITS	mm	SERIES	DS1138-11 SERIES

DRAWING TYPE	CUSTOMER		
SCALE	1:1	SHEET	1 OF 1
DRAWING NO.	C-DS1138-11-XXXXXX-B		

**晨翔电子有限公司**  
**CONNFLY CONNELY ELECTRONIC CO. LTD**

1                      2                      3                      4                      5                      6                      7                      8